

Deflector to protect shaft seals for PA/PAC pumps DEF 054111

This deflector ensures the protection of the pump shaft seals. In particular, it protects the pump from projections of dirt from the road in crankshaft drive installations.

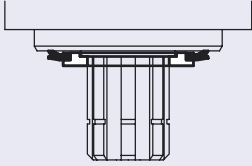

Cardan plate for PA/PAC pumps PLT 056315

The PLT 056315 cardan plate enables the pump shaft to be connected to a cardan shaft with interface as on drawing on the right.

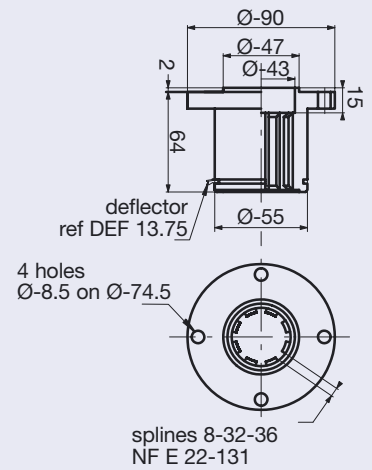

Shaft sealing

Hydro Leduc pumps destined for truck hydraulics (X, PA, PAC and TXV series) are all fitted with reinforced sealing comprising :

- two radial seals : an external seal adapted to the needs of PTOs and gearboxes ; and an internal seal adapted to the needs of hydraulic performance ;
- an **original** protection of the pump shaft seals. This is a flexible transparent tube which avoids any entry of contaminants between the two seals, and guarantees high pressure water jet cleaning of vehicle will not damage the sealing area. It also allows air vent of the chamber between the two seals.



✓ Recommendations for attaching the protective tube :

- make a siphon with the tube so as to avoid any introduction of :
 - dirt from road ;
 - water or damp from high pressure washing of vehicle ;
- put the end of the tube downwards, or in a place sheltered from any projections ;
- fix the tube in place using a collar/clip.

✗ Avoid :

- attaching the tube to any parts which may move, this could lead to it being damaged or torn off ;
- any pinching or folds in the tube when fixing it in place ;
- any obturation of the end of the tube.



HYDRO LEDUC stresses that on non-sealed PTO installations it is the hydraulic pump which ensures the sealing of the vehicle gearbox. This is why Hydro Leduc offers tried and tested solutions approved by vehicle manufacturers.

Note in particular the pump – PTO sealing via a frontal square section ring seal ensuring metal to metal contact between pump and PTO.

Examples of tube attachment

